

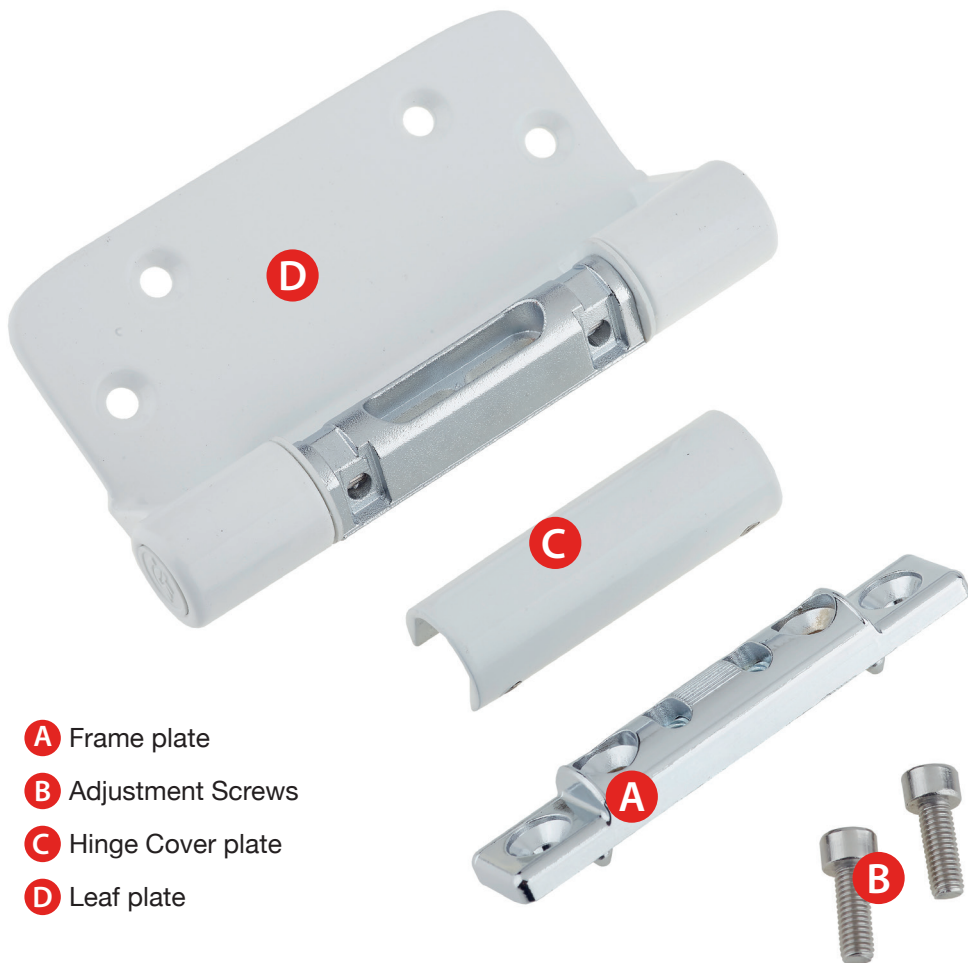

External Doors Online

Athena 2D Adjustable Hinge Instructions



- A** Frame plate
- B** Adjustment Screws
- C** Hinge Cover plate
- D** Leaf plate

Tools required

- 4mm Allen Key
- 2mm Allen Key

This hinge allows Lateral and Height adjustment of the door leaf.

Effective October 2017

Athena 2D Adjustable Hinge Instructions

Lateral Adjustment +/- 4mm



Lateral Adjustment: (Note Lateral and height adjustment can be made simultaneously)
Slacken off both M5 Cap Head Screws **on all hinges** (and ensure they are **re-tightened** after adjustment)
The Door can now be moved one way or the other about the nominal position

Height Adjustment +/- 4mm

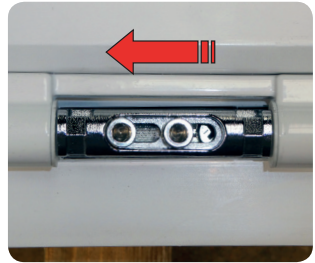
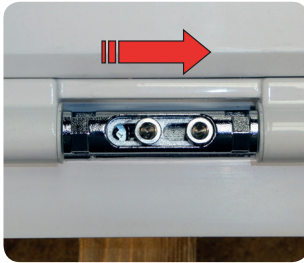

Lateral Adjustment: (Note Lateral and height adjustment can be made simultaneously)
Slacken off both M5 Cap Head Screws **on all hinges** (and ensure they are **re-tightened** after adjustment)
The Door can now be moved one way or the other about the nominal position

Fitting the Cover

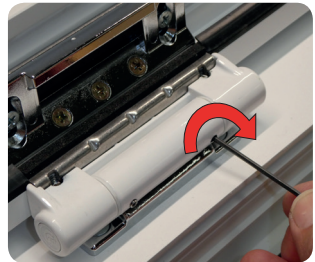

Place Cover over Hinge Knuckle with Grub Screws facing inwards towards Door Sash
Open the door to expose the grub screws and tighten using a 2mm Allen Key

Effective October 2017